



FIR TREE RIVETS

BPF Series
Barbed Push Fastener

Specifications:

- Material: Nylon 6/6
- Color: Black

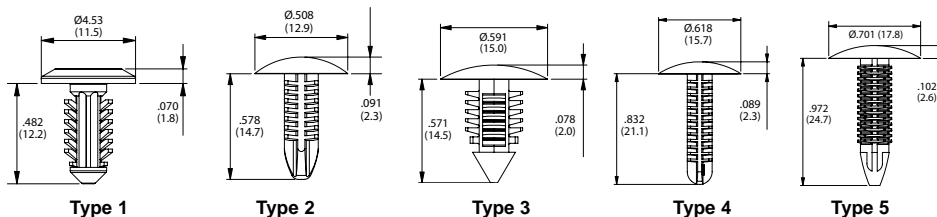

Item No.	Hole Dia.		Panel Thickness		Head Dia.		Lock Length		Head Thickness		Type	Material	Pack Qty.
	in	mm	in	mm	in	mm	in	mm	in	mm			
BPF-A414	0.185	4.7	0.031 - 0.118	0.8 - 3.0	0.453	11.5	0.482	12.2	0.070	1.8	1	UL94V-0	1000
BPF-F4410	0.197	5.0	0.059 - 0.295	1.5 - 7.5	0.508	12.9	0.578	14.7	0.091	2.3	2	UL94V-2	1000
BPF-F3T31	0.197	5.0	0.079 - 0.394	2.0 - 10.0	0.618	15.7	0.832	21.1	0.089	2.3	4	UL94V-0	1000
BPF-F2495	0.276	7.0	0.125 - 0.236	3.2 - 6.0	0.591	15.0	0.571	14.5	0.078	2.0	3	UL94V-0	1000
BPF-F1G12	0.276	7.0	0.079 - 0.591	2.0 - 15.0	0.701	17.8	0.972	24.7	0.102	2.6	5	UL94V-0	1000

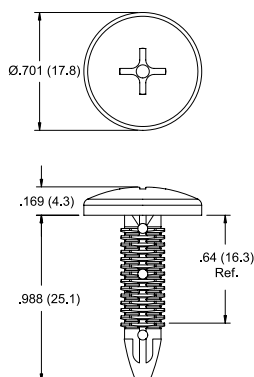
BPFR
Removable Fir-Tree Rivet

Specifications:

- Material: UL94 V-0 Nylon 6/6
- Color: Black

Features:

- Removable from threaded holes using a phillips head screwdriver

Item No.	Threaded Hole	Non-Threaded Hole Ø	Minimum Panel Thickness	Pack Qty.
BPFR-1	5/16 (M8)	.276 (7)	.236 (6)	1000

PL Series
Pawl Lock

Specifications:

- Material: Nylon 6/6
- Color: Natural
- Flame Class: UL94V-2



Type 1

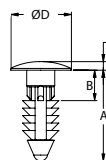

Type 2

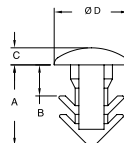

Item No.	Type	Hole Dia.		Spacer Length B		Head Dia. D		Lock Length A		Head Thickness C		Pack Qty.
		in	mm	in	mm	in	mm	in	mm	in	mm	
MPLE-3.2M-01	2	0.126	3.2	0.080	2.0	0.190	4.8	0.190	4.8	0.040	1.1	1000
MPLE-32M/35M-01	2	0.126 - 0.138	3.2 - 3.5	0.080	2.0	0.190	4.8	0.200	5.2	0.040	1.1	1000
PL-250-10-01	1	0.250	6.35	0.125	3.2	0.500	12.7	0.606	15.4	0.078	2.0	1000
PL-250-12-01	1	0.250	6.35	0.264	6.7	0.500	12.7	0.751	19.1	0.070	1.8	1000
PL-250-20-01	1	0.216	5.5	0.082	2.1	0.354	9.0	0.984	25.0	0.070	1.8	1000

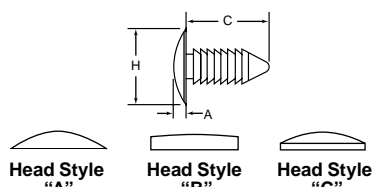
FR Series
Fir Tree Fasteners

Specifications:

- Material: Nylon 6/6
- Color: Black

Features:

- Ideal for threaded, non-threaded, drilled or punched holes
- Suitable for wide ranges of panel thicknesses and materials

Item No.	Hole Size		Panel Thickness Range In	Head Style	H		A		C		Pack Qty.
	in	mm			in	mm	in	mm	in	mm	
FR001A	0.187	4.75	0.025 / 0.365	A	0.375	9.52	0.070	1.77	0.500	12.70	1000
FR002A	0.187	4.75	0.030 / 0.330	B	0.435	11.04	0.068	1.72	0.562	14.27	1000
FR003A	0.187	4.75	0.125 / 0.450	C	0.300	7.62	0.065	1.65	0.700	17.78	1000
FR004A	0.250	6.35	0.105 / 0.300	A	0.700	17.78	0.100	2.54	0.473	12.01	1000
FR005A	0.250	6.35	0.150 / 0.535	A	0.700	17.78	0.107	2.71	0.783	19.88	1000
FR006A	0.281	7.13	0.093 / 0.500	A	0.625	15.87	0.110	2.79	0.890	22.61	1000